

Precision live centers extended, with head angle 60°

- ✓ Possibility of using the live centers on CNC machine tools.
- ✓ Special seals prevent the ingress of process liquid and dust particles.

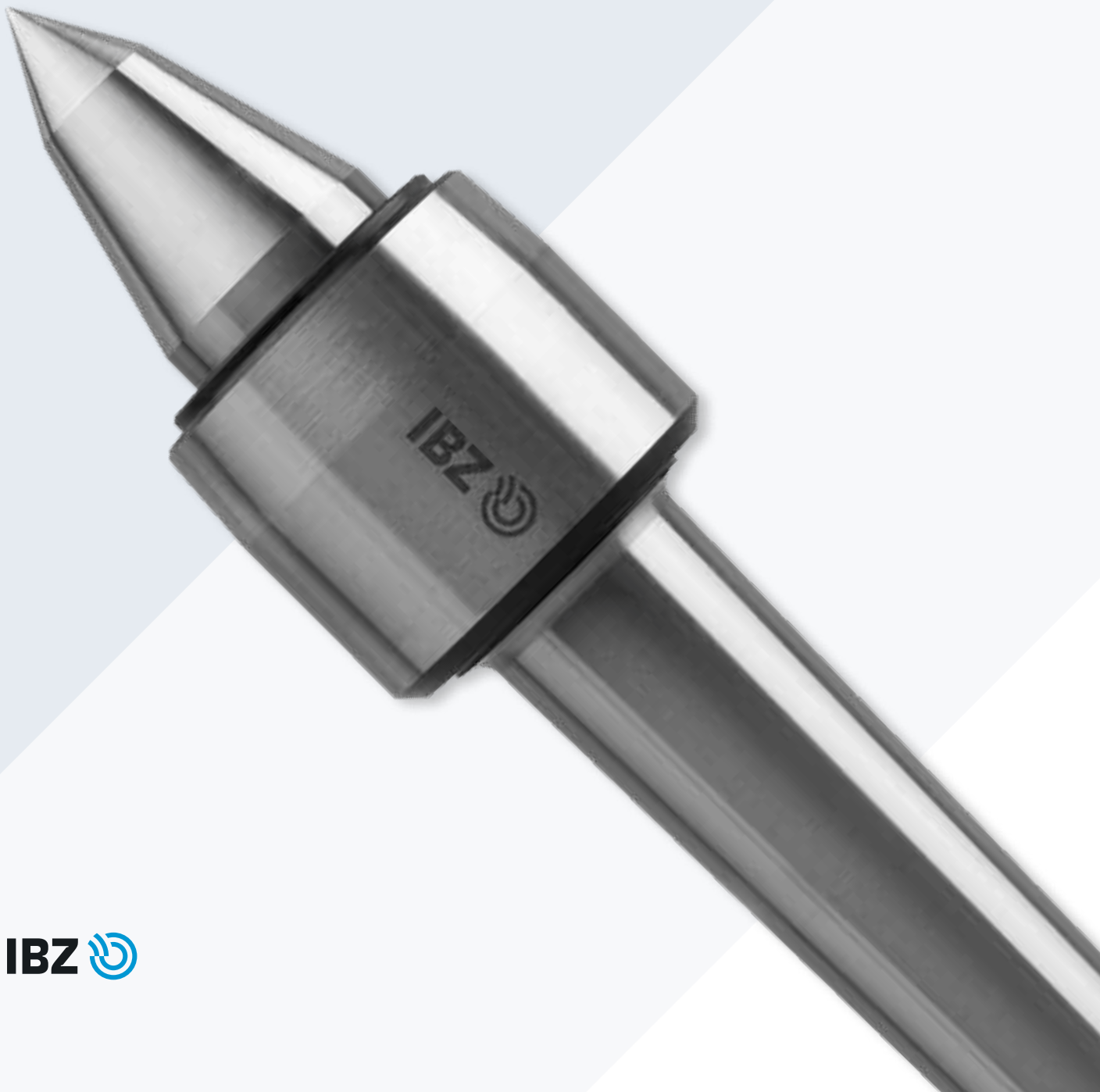

The live centers are designed for work on lathes. The extended clamping part allows easy access of the tool to the workpiece, which is very advantageous when machining with replaceable tool bits.

ČSN 24 3328

The construction of the live centers allows the radial clearance to be adjusted. The centers have a MORSE taper shank according to ČSN standard ISO 296. In a special design – the live centers can be manufactured with the shape and lining of the rotating part according to the customer's requirements.

The live centers are supplied with lithium-based grease Mogul LV2-WR. Disassembly of the live centers – except for authorized service – is not recommended.

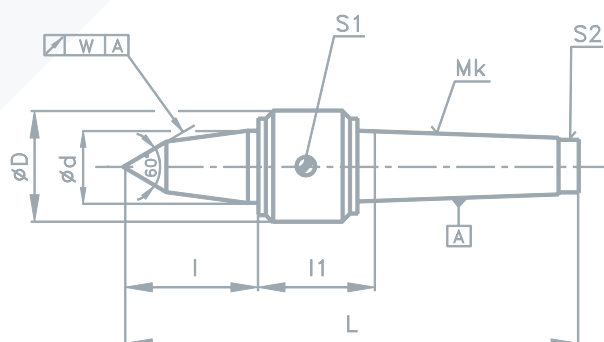

Mk	MORSE taper shank
n	max. rotation speed (rpm)
Q	max. workpiece weight (kg)
m	product weight (kg)
w	concentricity accuracy (mm)

Mk	Ø D	Ø d	L	l	l1	n	Q	m	w	catalogue no.
2	36	20	128,5	24	41	6 000	270	0,36	0,01	21-71282
3	47	28	167	34	53	5 000	320	0,84		21-71283
4	55	35	207,5	49	56,5	4 000	1000	1,45		21-71284
5	69,5	45	259	66	63	3 500	1600	3,2		21-71285
6	89	60	341	82	79	2 500	3 200	7,75		21-71286