

# Precision live centers for NC and CNC lathes

- ✓ The construction of the live center meets the special functional requirements due to the use of a special bearing.
- ✓ Possibility of using live centers on NC and CNC machine tools.
- ✓ Special seals prevent the ingress of process liquid and dust particles.



The live centers are designed for workpieces clamping on NC and CNC machine tools. The clamping part allows an easy access of the tool to the workpiece, which is advantageous when machining shaped parts.

### ČSN 24 3327

The construction of the live centers allows adjustment of the clearance in the front radial bearing. The live centers are equipped with a shank with a MORSE taper according to ČSN standard ISO 296.

The live centers are supplied with lithium-based grease Mogul LV2-WR. Disassembly of the live centers - except for authorized service - is not recommended.

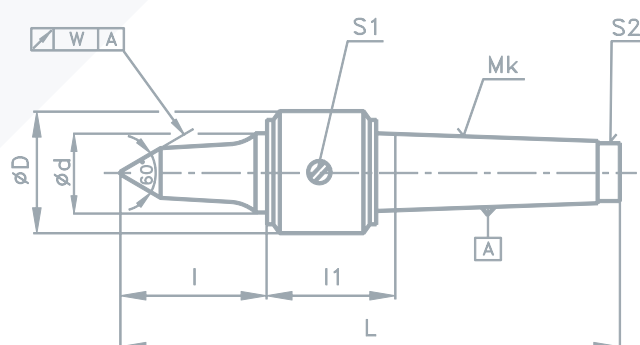

<b>Mk</b>	MORSE taper shank
<b>n</b>	max. rotation speed (rpm)
<b>Q</b>	max. workpiece weight (kg)
<b>m</b>	product weight (kg)
<b>w</b>	concentricity accuracy (mm)

Mk	Ø D	Ø d	L	l	l1	n	Q	m	w	catalogue no.
2	36	17	131	26	42	6 000	270	0,39	0,005	21-70272
3	47	25	170	33	57	5 000	320	0,89		21-70273
4	55	30	206	42	62	4 000	1 000	1,4		21-70274
5	70	40	257	54	73	3 500	1 600	3,2	0,002	21-70275