

# Precision live centers with small head diameter and with a crest angle 60°

- ✓ Application for centering and clamping workpieces especially on semi-automatic lathes with 2-3 turning carriages.
- ✓ The reduced diameter of the housing allows better access to the workpiece.
- ✓ A special seal prevents the ingress of process liquid and dust particles.
- ✓ Possibility to use the live centers on grinders.



The live centers are designed for workpiece clamping on lathes, possibly also for work on grinders.

### ČSN 24 3315

The construction is characterized by a small diameter of the head  $\varnothing D$  compared to the basic series of other live centers according to ČSN 24 3324, which allows easy access of the tool to the workpiece. The live centers are provided with MORSE taper shank according to ČSN ISO 296. A special shaft seal prevents the penetration of process fluids into the bearing space of the housing, clogging of dust and mechanical impurities during machining - that extends the life of product.

The live centers are supplied with lithium-based grease Mogul LV2-WR. Disassembly of the live centers - except for authorized service - is not recommended.

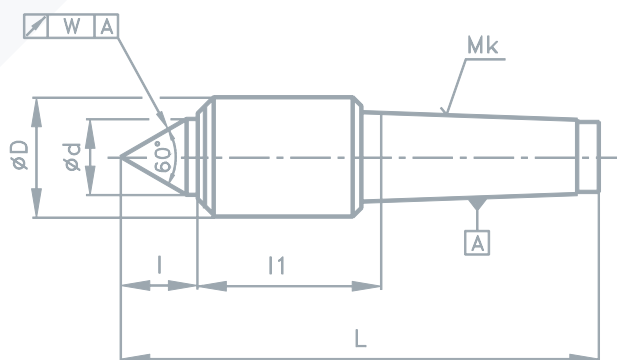

<b>Mk</b>	MORSE taper shank
<b>n</b>	max. rotation speed (rpm)
<b>Q</b>	max. workpiece weight (kg)
<b>w</b>	concentricity accuracy (mm)

Mk	Ø D	Ø d	L	l	l1	n	Q	w	catalogue no.
2	34	15	126	18	44	6 000	180	0,005	21-22041
3	36	16	144	19	44	5 000	400		21-12370
4	42	20	177	24	50,5	5 000	700		21-14296
5	60	30	226	35	61,5	4 000	1000		21-27443