

Precision live centers with replaceable inserts and special push-off nut

- ✓ Special seals prevent the ingress of process liquid and dust particles.
- ✓ Replaceable inserts expand the possibilities of using centers.
- ✓ Possibility of using centers on CNC machine tools and grinders.
- ✓ Possibility of using centers during machining or measuring.



The centers are designed for centering and clamping workpieces on classic NC and CNC lathes. Their clamping part allows easy access of the tool to the workpiece, which is advantageous – when machining shaped parts.

ČSN 24 3314

The construction of the centers allows adjustment of the clearance in the front radial bearing. The live centers are provided with MORSE taper shank according to ČSN standard ISO 296. Replaceable inserts enable universal use for production of various single workpieces. Depending on the used replaceable insert – the workpieces can be clamped in different ways – for example at the inside diameter of pipes, etc.

The rotating part of the live center is provided with a conical cavity and therefore various clamping inserts can be inserted as needed. The inserts must be pressed into the cavity with a clamping force (tailstock). The clamping insert can be removed with help of a special punching fork. In addition to the use of replaceable inserts, the live center is equipped with a special pusher nut for easy removal from the tailstock of the machine. A special sealing ring prevents the ingress of process liquid and dust particles into the bearing spaces of the live center – which significantly extends its durability.

The live centers are supplied with special lithium-based grease – Mogul LV2-WR. Disassembly of the live centers – except for authorized service – is not recommended.

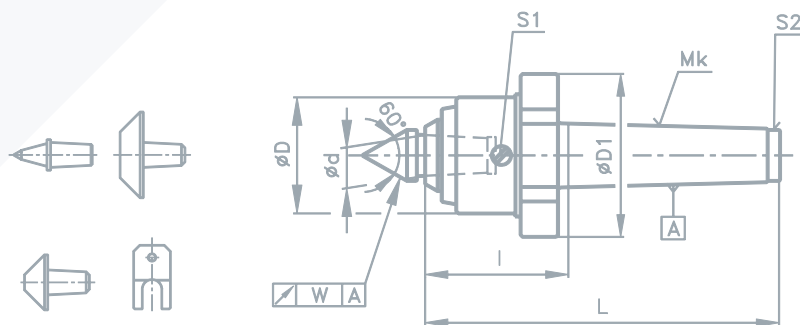

Mk	MORSE taper shank
n	max. rotation speed (rpm)
Q	max. workpiece weight (kg)
m	product weight (kg)
w	concentricity accuracy (mm)

Mk	Ø D	Ø D1	Ø d	L	I	n	Q	m	w	catalogue no.
3	52	75	15	143	63	5 000	400	1,65		21-14292
4	55	80	20	171	69	4 000	1 300	3,05	0,012	21-14293
5	69,5	95	25	213	84	3 500	2 000	6,1		21-14294